



P.O. Box 23 Limington, ME 04049
(207) 221-5822
www.zebralovewebsolutions.com
milly@zebralovewebsolutions.com

Last Updated: 10/26/2021

Adding your cPanel email to Windows 10 Mail App

Step 1: Click on the settings icon in the bottom left hand corner of the mail client.



Step 2: Click **Manage accounts**

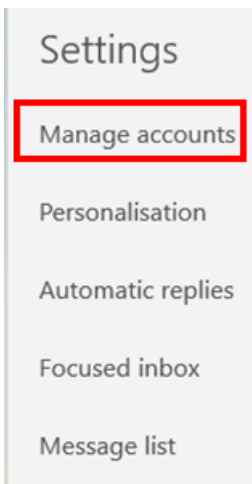

Step 3: Click **+ Add Account**

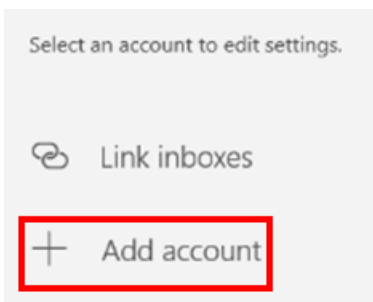

Step 4: Click **Advanced Setup**

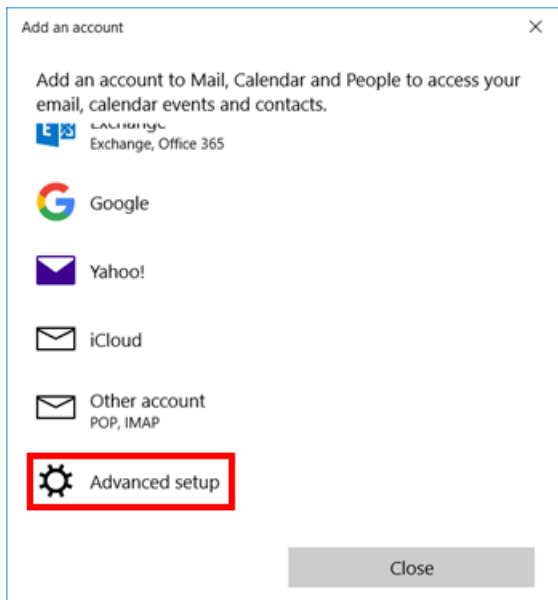

Step 5: Click Internet Email

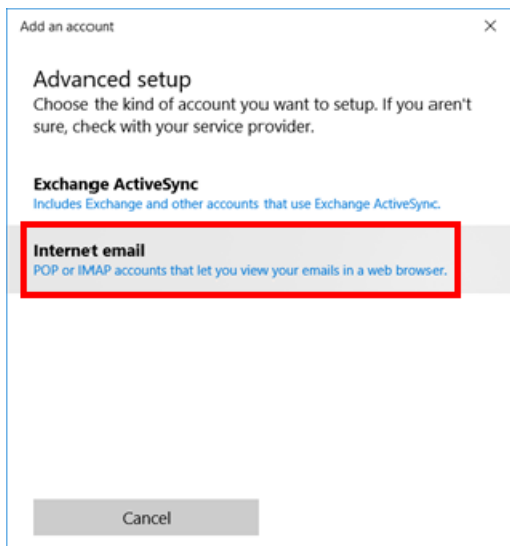

Step 6: Next you will be asked to fill out the following information with the correct information for your specific email address.

Email Address: youremail@yourdomainname.com

Username: youremail@yourdomainname.com

Password: your email account's password.

Account Name: youremail (taken from youremail@yourdomainname.com)

Send your messages using this name: Whatever name you would like to appear on emails.

Incoming email server: zeb.zebralovehost.com

Account Type: IMAP4

Outgoing email server: zeb.zebralovehost.com

Make sure Outgoing server requires authentication is ticked.

Make sure Use the same username and password for sending emails is ticked.

Make sure Require SSL for incoming emails & Require SSL for outgoing emails are ticked.

Step 7: Click Sign in



Now your account should be completely set up. If your emails aren't showing up straight away click the sync button at the top of your inbox to re-sync your mailbox to our server.



Helpful Links:

You can use the free browser based mail client provided with your email account.

WebMail: zeb.zebralovehost.com:2096